

DUBOIS 70



OUTBOARD PROFILE

Specifications

SPECIFICATIONS

DUBOIS 70

L.O.A.	21.20 m
Beam	10.68 m
Builder	McConaghy Boats
Designer	Dubois Naval Architects & Yacht Design

SAIL AREA

Main	131.60 m ²
Blade	102.30 m ²
Genoa	168.00 m ²
Staysail	42.10 m ²

CONSTRUCTION

The hull, deck and superstructure will be of composite construction E'Glass with foam cores. Primary parts shall be resin infused. High load areas will be locally reinforced; Composites will be post cured at elevated temperature.

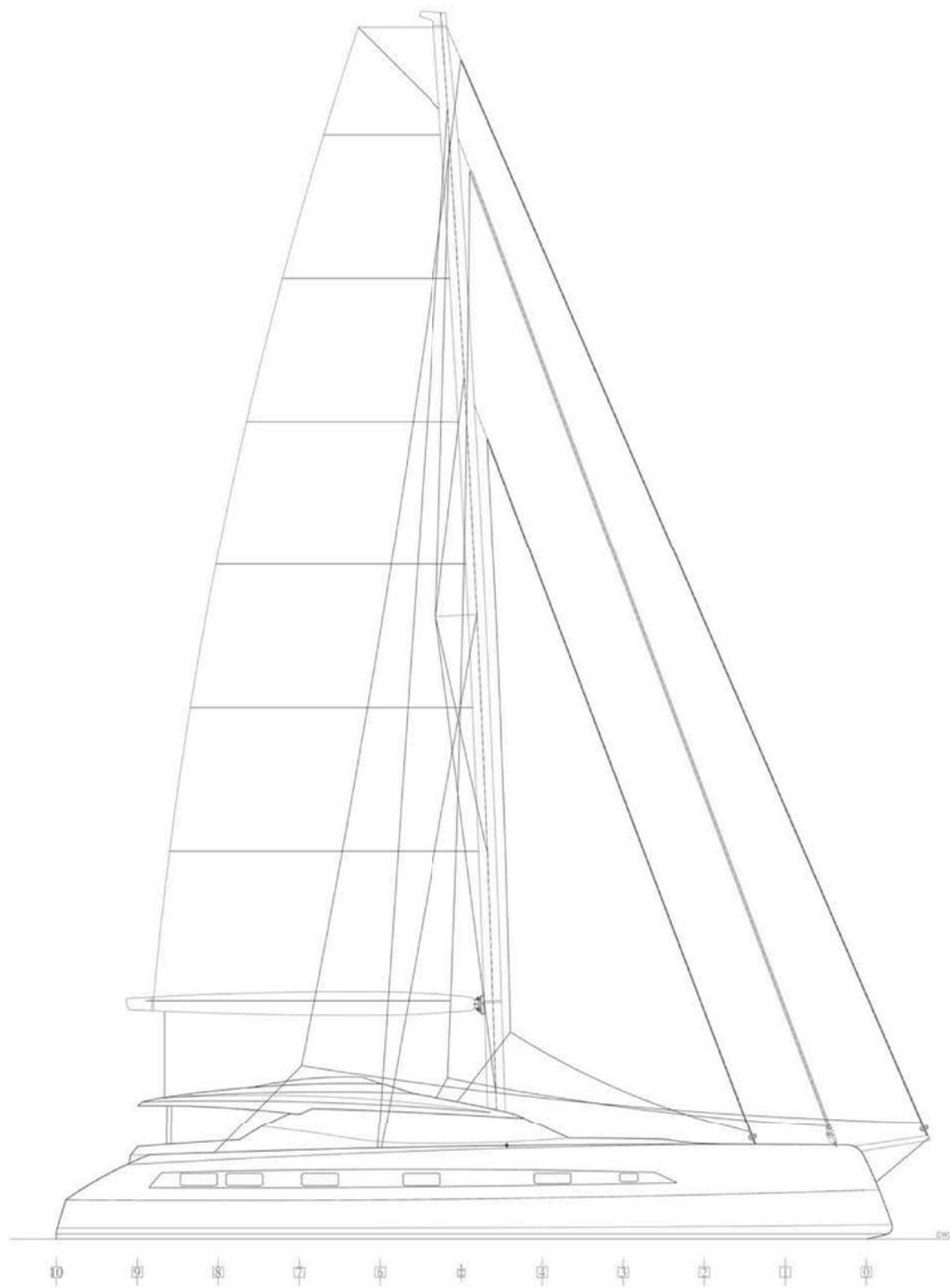

OUTBOARD PROFILE

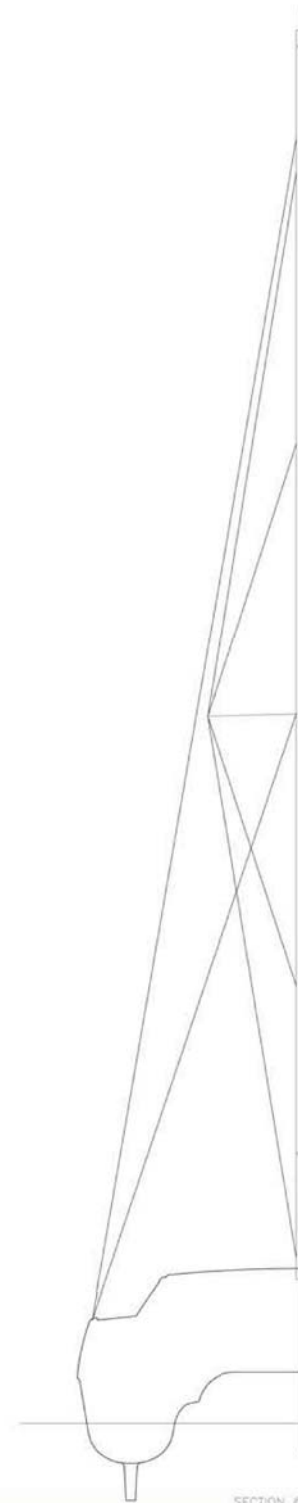

SECTION @ STN. 5

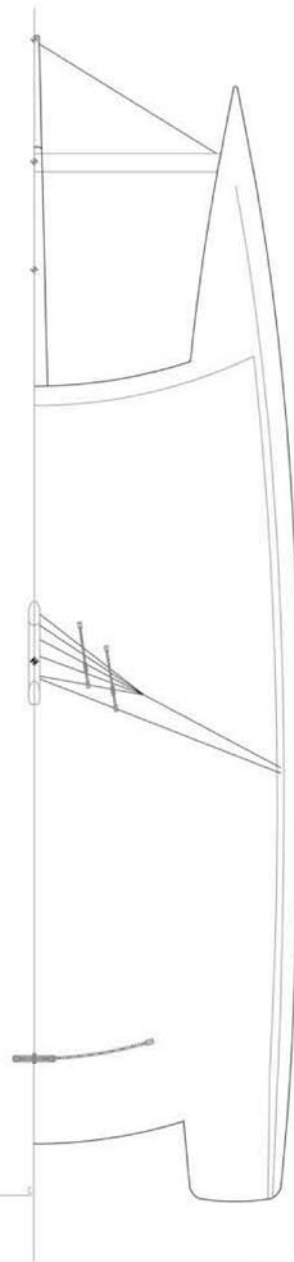

PLAN

FINISHES

DUBOIS 70

EXTERIOR FINISH

Exterior painting is single light colour, non metallic urethane

INTERIOR FINISH

Hull sides, bulkheads and exposed structure shall be painted in satin white lined in headliner or veneer finish.

Furniture shall be built wherever possible 'out of the vessel' and fitted after painting. Furniture shall be lightweight plywood, veneered and satin clear finished 30% grain filled.

Separate saloon and cockpit dining tables, veneered finish, no other loose furniture has been allowed for

General Finish shall be high standard, similar to photos below



DUBOIS 70

HEADLINERS

Lightweight headliners in the following areas:

- Saloon
- Port Hull Accommodation areas (not in heads)
- Starboard Hull Accommodation areas (not in heads)
- Cockpit overhead headliner shall be composite (no soft fabric covering)

FLOORS BELOW DECK

Floors in accommodation and living areas shall be 'timber style finish' Altica or Formica style faced composite panels.

INTERIOR FIT OUT

Interior layout as per Dubois Internal GA

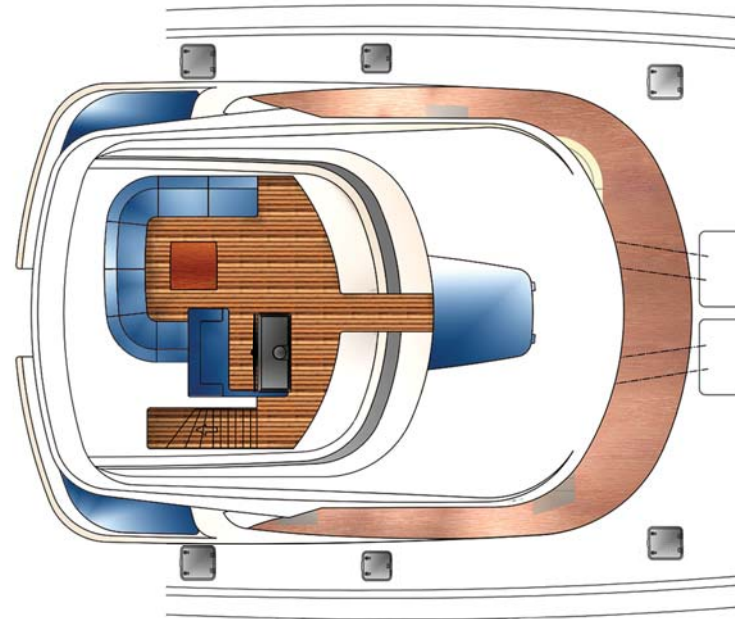

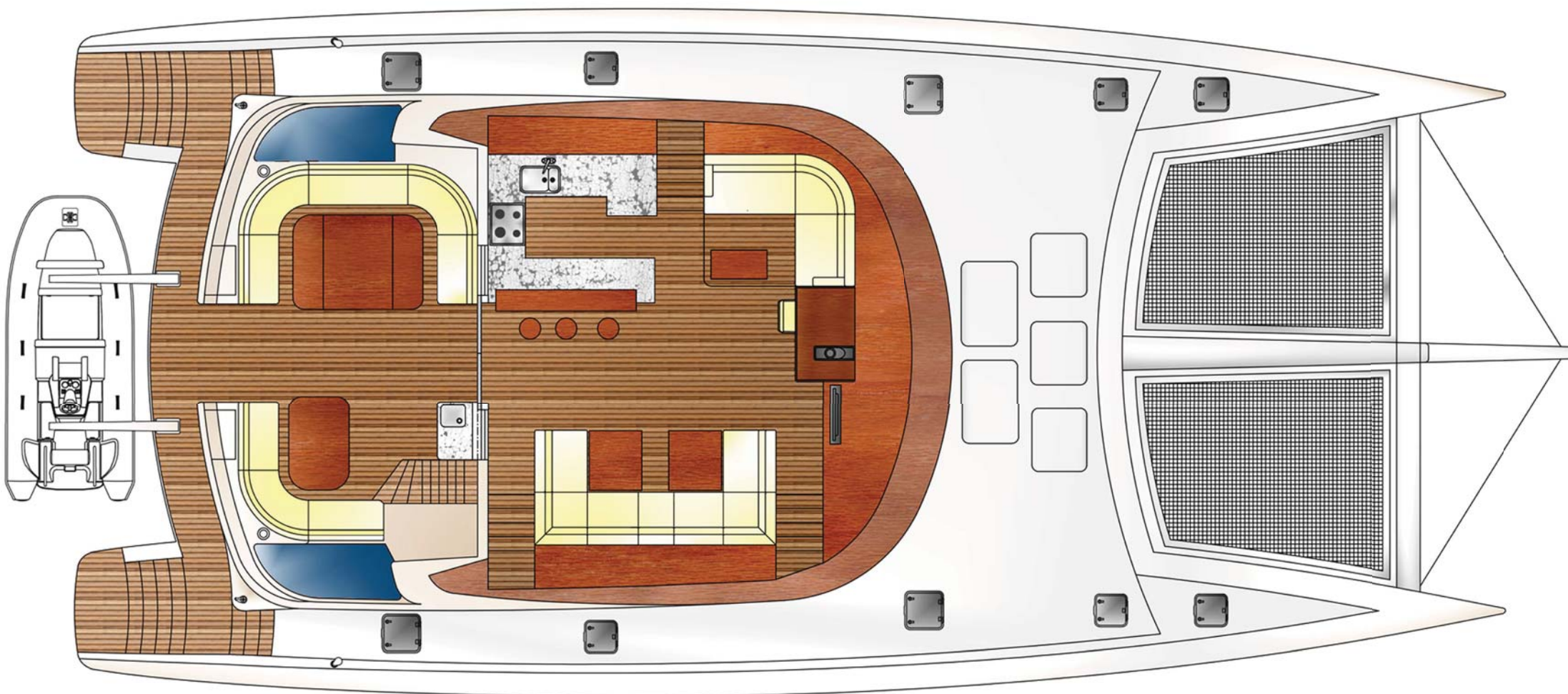

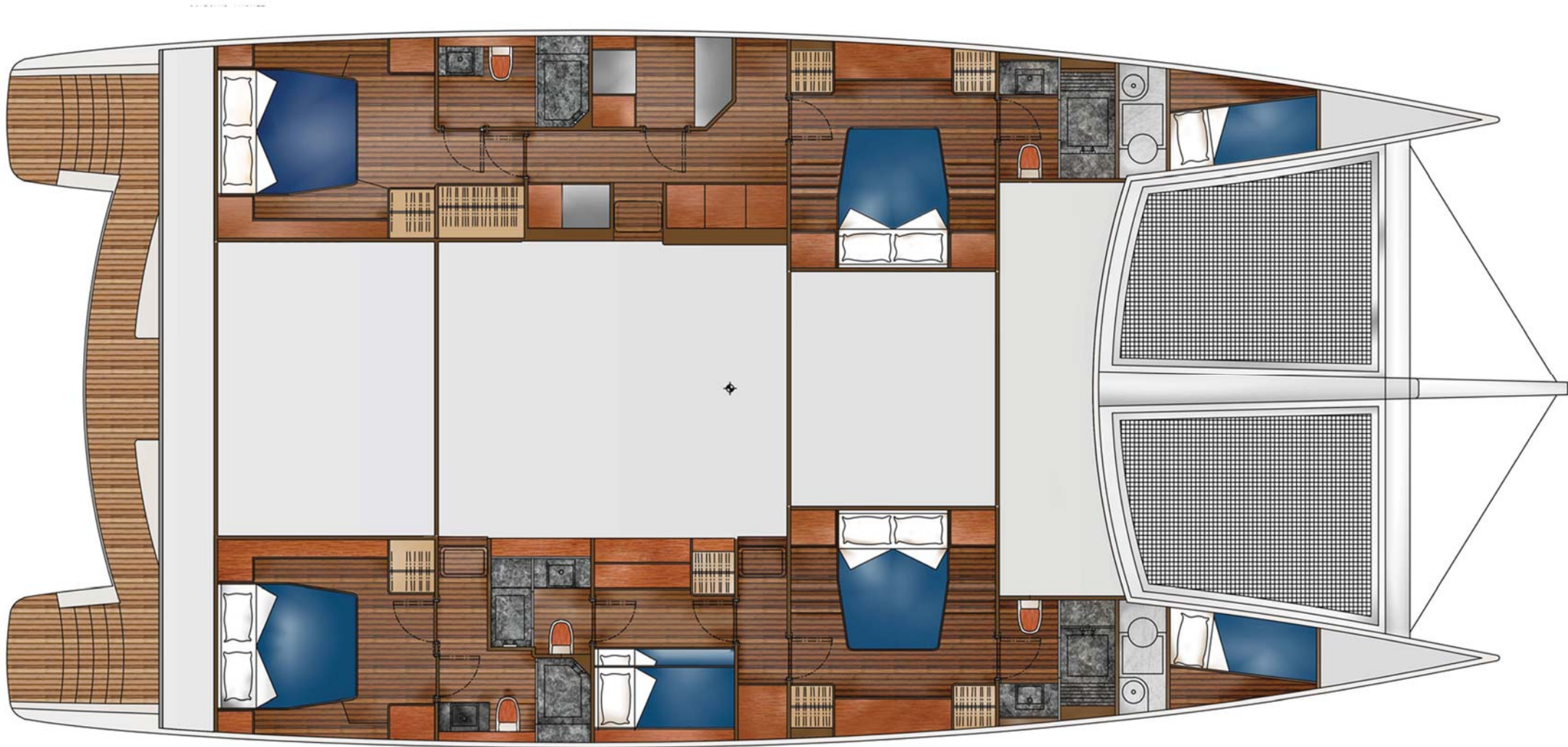

DUBOIS 70

FIVE ENSUITRE HEADS

All heads fitted with electric toilets

Corian bench tops with integral corian basins, and mirror fitted above sink

Hot and cold mixer faucet, fitted adjacent to each sink

All heads fitted with showers, clear acrylic shower doors, hot and cold mixer faucet and shower drain

Non-corian surfaces painted in satin white

Floor shall have painted non-skid applied

GALLEY

Galley shall include shelves, cabinets and draws, final layout to be determined.

Draws shall be fitted with ball bearing tracks and soft close.

Counter top to be corian.

Pressurized hot / cold water faucet and double stainless sink.

Galley equipped with the following:

1 x washer

1 x trash compactor

1 x gas stove with oven

1 x single door under counter refrigerator

1 x wine cabinet

1 x dryer

1 x dishwasher

1 x microwave

1 x single door under counter freezer

1 x ice maker

UPHOLSTERY

All exterior upholstery allowed for in Sunbrella (standard range) fabric.

Fly bridge Settee

Fly bridge Seat

Main deck Settee

Sunpads

Beds



OUTBOARD PROFILE

SYSTEMS

MECHANICAL

Main engine, gearbox and shafting, engine system same port and starboard.

Yanmar4JH3-DTE 125hp Engine

KMH41 (2.45) gear box

Aquadrive Shaft thrust bearing

Aqually 22 conventional shaft arrangement

PSS Shaft seal

Gori 3-Blade folding propeller

Glendinning electronic engine controls

ENGINE ROOM INSULATION & VENTILATION

Soundown Insulation

Each engine fitted with Delta 9" 24V.dc fan

FUEL SYSTEM

Two integral fuel tanks, approx 375 litres with two racor fuel filters per tank

AIR CONDITIONING

Separate Frigomar system for hulls and saloon areas:

2 x 60k Btu chiller units supplying to both hulls & saloon.

Total of 10 air handlers, 2 for saloon , 8 to be placed in cabins

DUBOIS 70

SEA WATER SYSTEMS

One Seawater wash down kit

BILGE SYSTEM

Four rule automatic bilge pumps in each hull

Two Henderson manual bilge pump with "roaming" pickup hose

BLACK WATER

Black water tanks

Each tank fitted with thru-hull discharge, deck fill and self priming discharge pump.

FRESH WATER SYSTEM

1 x 375 Ltr integral water tanks built into each hull.

Each tank shall have its own deck fill and tank breather.

Pressurized fresh hot and cold water system

80 ltr hot water heater

2 x Freshwater pressure pumps and pressure storage tanks (one port, one starboard)

2 x Freshwater washdown kits. One close to anchor windlass, the second at aft starboard transom.

ELECTRICAL

ELECTRICAL SYSTEM

The electrical system is controlled by a BEP C-Zone can bus system

BATTERIES AND CHARGING SYSTEM

1x Mastervolt Mass Combi Inverter / Charger with 24vdc-2500W inverter – 60A charger

6x Mastervolt gel batteries 24v 160Ah

2x Mastervolt Starting Batteries 12v 70 Ah

1x Mastervolt DC/DC Converter 24v - 12v

GENERATORS

1 x 17.5kW Onan (approx.) day time generator (Start 24Vdc)

VESSEL LIGHTING

LED lights, down lights, courtesy lights, strip lights

DUBOIS 70

NAV LIGHTS

LED 3 colour masthead

LED anchor light

LED steaming light

ADDITIONAL ELECTRICAL APPLIANCES AND EQUIPMENT

10 x 220v AC Outlets

2 x 12v DC Outlets (internal)

1 x 12v DC Outlets (for tender pump)

1x 32" Samsung TV (LCD)

Shore power, 30A Galvanic Isolator, Shore power cable, plug and inlet.

HARDWARE

STEERING

Single steering position at flybridge and at saloon navigation station

McConaghy carbon autoclaved carbon fibre steering wheel

Hydrive hydraulic steering control

PORTLIGHTS, HATCHES AND GLAZING

Total of 10 x McConaghy custom deck hatches with glazing. Each hatch fitted with gas strut and McConaghy carbon handles.

Total of 14x McConaghy custom composite deck hatches / locker lids. Each lid fitted with gas strut and Sea Smart (L70) stainless latch. Final positions to be determined.

Total of 12 x fixed portlights installed to hull topsides.

Main saloon forward and side glazing to be tinted 10mm laminated glass.



DUBOIS 70

ANCHORING

Lewmar V4/V5 Windlass
50kg Delta galvanised anchor
30M x 10mm short link galvanized chain
80M x 22mm rope

MOORING

Eight Nomen folding cleats

MOORING

Eight Nomen folding cleats

DAVITS

Twin, permanently dixed davits fitted to aft deck

2 x Harken Performa 2 Speed self tailing winches
with elcetric motor

DECK RAILS

McConaghy composite stanchions, pulpits, push-
pits and wire lifelines

TRAMPOLINE

Port and starboard trampoliness

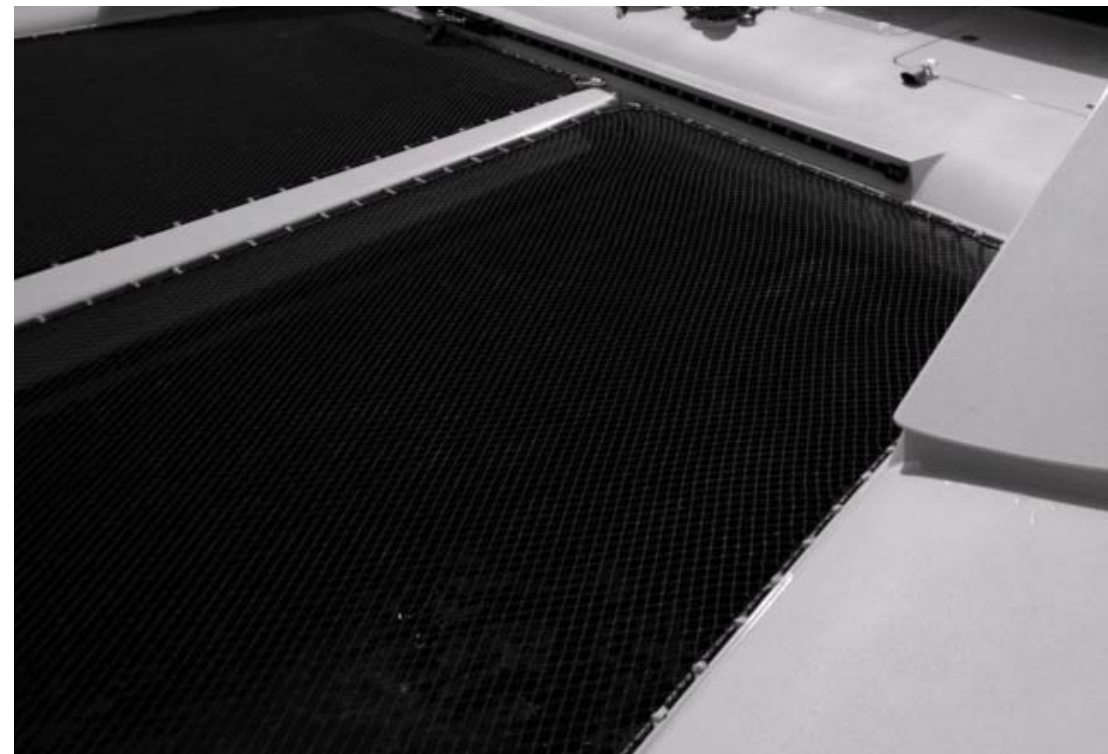



DECK HARDWARE

Harken deck hardware package

4 x Flybridge winch: Harken 80.3 STEP Performa electric self tailing

1 x Mast winch: Harken 60.3STP Performa self tailing

1 x Traveller winch: Harken 50.2 STEP Performa electric, self tailing

1 x Spinnaker winch: Harken 80.3 STEP Performa electric, self tailing

2 x Davit winch: Harken Performa electric, self tailing

Harken winch handles and McConaghy carbon fibre winch handle pockets

Spinlock jammers and custom organisers

RIG PACKAGE

Aluminium Mast, and boom

One Set of tapered spreaders

Running Rigging Package

Wire Standing Rigging

ELECTRONICS

NAVIGATION & COMMUNICATIONS INSTRUMENTS

3 x Triton T41 Displays
1 x Rate Compass
1 x Pilot Ram Type 2 24vdc
2 x Triton Pilot Controller
1 x Triton Pilot Computer, High Current
1 x ZG50 GPS ANTENNA, ZEUS, 5Hz
Triton Speed / Depth / Wind pack
1x Triton Digital Display, T41
1x Speed/Depth/Temperature sensor
1x Triton Wind Sensor Pack with 20m cable
2 X Zeus 12 Chart Plotter
1 x RF25N, Rudder Feedback Unit
NAIS-400 SYSTEM, CLASS B-AIS W/GPS
VHF/AIS 30m cablepack
VHF 1.1m stainless steel antenna & mounting
bracket & SO239 socket
VHF MARINE RADIO, RS35, DSC

DUBOIS 70

FUSION ENTERTAINMENT SYSTEM

1 x Fusion DVD Stereo
6 x Fusion 6" Speakers
1 x Fusion I POD Cable
1 x Primary Head Unit and secondary fly bridge control
unit

SAILS

DUBOIS 70

Sail Type	Area(m^2)	Construction	Fabric	Cut
Mainsail	131.60	Tetraneema	TRL40	Radial
Genoa 120%	168.00	Tetraneema	TRL30	Radial
Blade Jib	102.30	Tetraneema	TRL40	Radial
Staysail	42.10	Tetraneema	TRL40	Radial
Gennaker	225.00	Nylon	2.2oz Nylon	Triradial
ATN sleeve for gennaker				
Lazy Cradle Acrylic				

McCONAGHY